



Blossom Bridge Project Stakeholder Committee Meeting 2



Purpose & Need

The existing bridge was constructed in 1953, rehabilitated in 1987, and has a sufficiency rating of 56.0 based on a scale of 100.^{1,2} The existing bridge is considered structurally deficient due to deteriorating integrity of the bridge structure. The purpose of the proposed project is to replace the structurally deficient Blossom Street Bridge over CSX Transportation and Norfolk Southern Railroads to meet current standards.

¹ SCDOT, The Office of Bridge Maintenance, National Bridge Inventory: Structure Inventory and Appraisal Report, June 15, 2017.

² SCDOT Bridge Inspection Form, January 22, 2018.

* Structurally deficient is a status used to describe a bridge that has one or more structural defects that require attention and does not mean that the bridge is currently unsafe

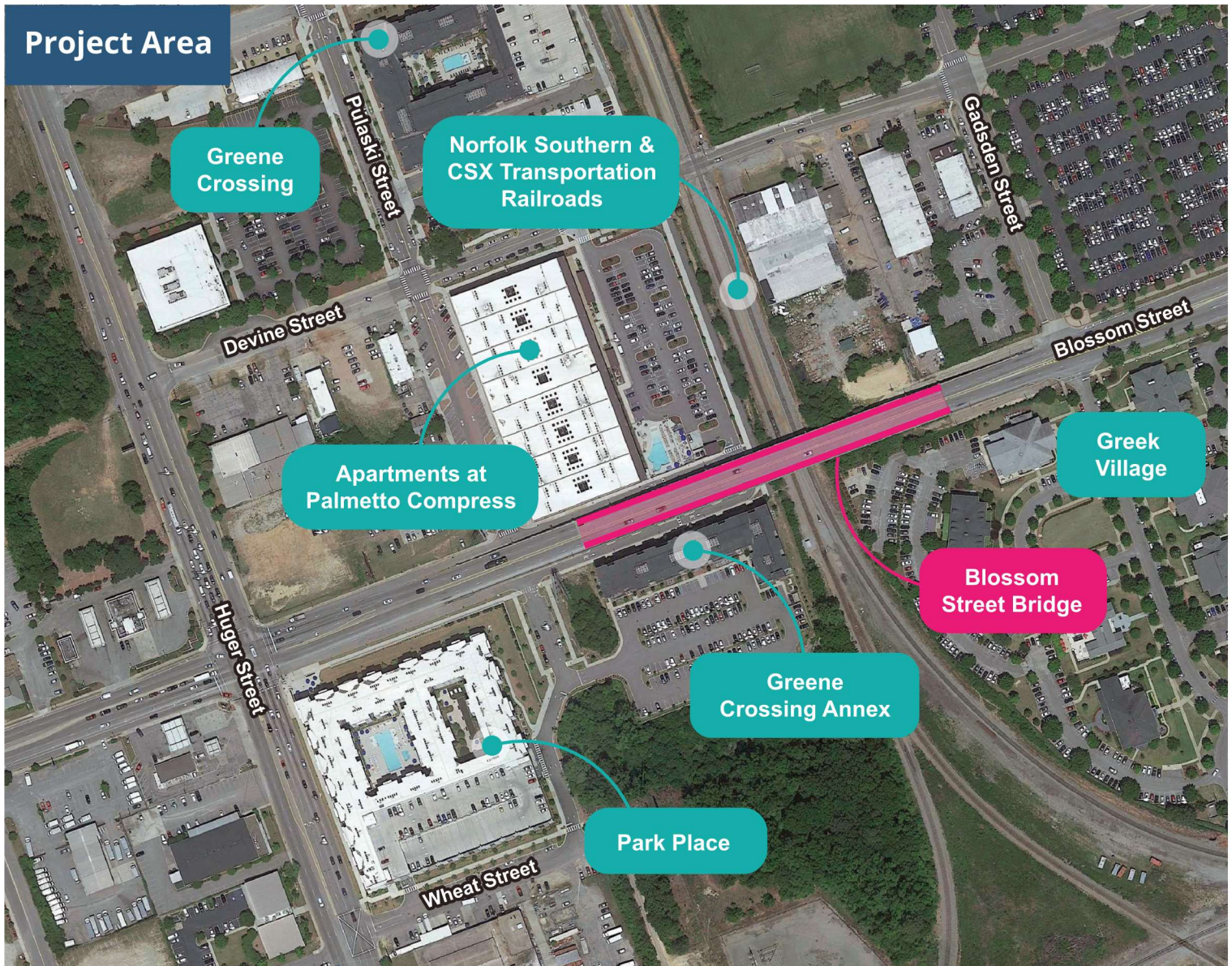

Traffic Analysis Options Being Studied

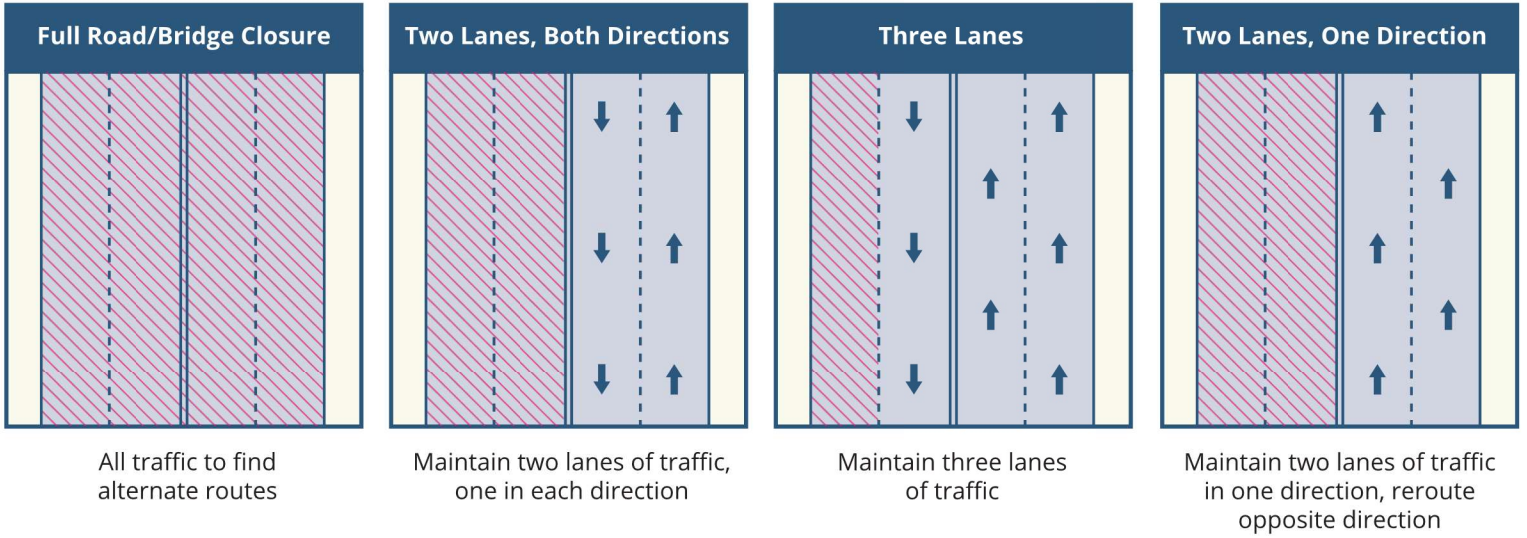

Traffic Analysis How to evaluate the options



Project Next Steps

